

Vacant Lands

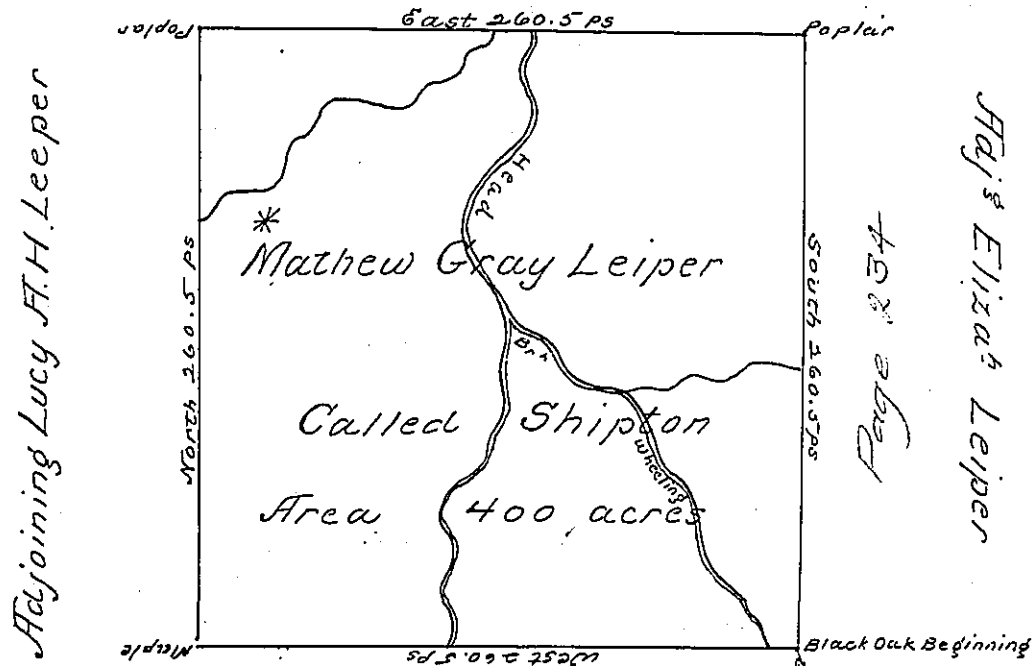

Adjoining Benj. McCulloch

The above is a Draught of a Survey made
 1st Feb 8 1785 In pursuance of a Warrant granted
 to Mathew Gray Leiper dated the 25th Day of Octbr
 1784 Situate on the headwaters of Wheeler Creek
 adjoining land Survey'd for Elizabeth Leiper in
 Washington County Called Shipton containing
 four hundred acres with the usual allowance of
 6 percent for Roads -

Ino. Hoge L.S.
 To John Lukens Esqr. Surv. Genl. }

* Say Martha

IN TESTIMONY that the above is a copy of the original remaining on file in
 the Department of Internal Affairs of Pennsylvania, made
 conformably to an Act of Assembly approved the 16th day of
 February, 1833, I have hereunto set my Hand and caused
 the Seal of said Department to be affixed at Harrisburg,
 this second day of July 1901

James W. Latta
 Secretary of Internal Affairs.